

SCHNITT 1-1 SEZIONE 1-1

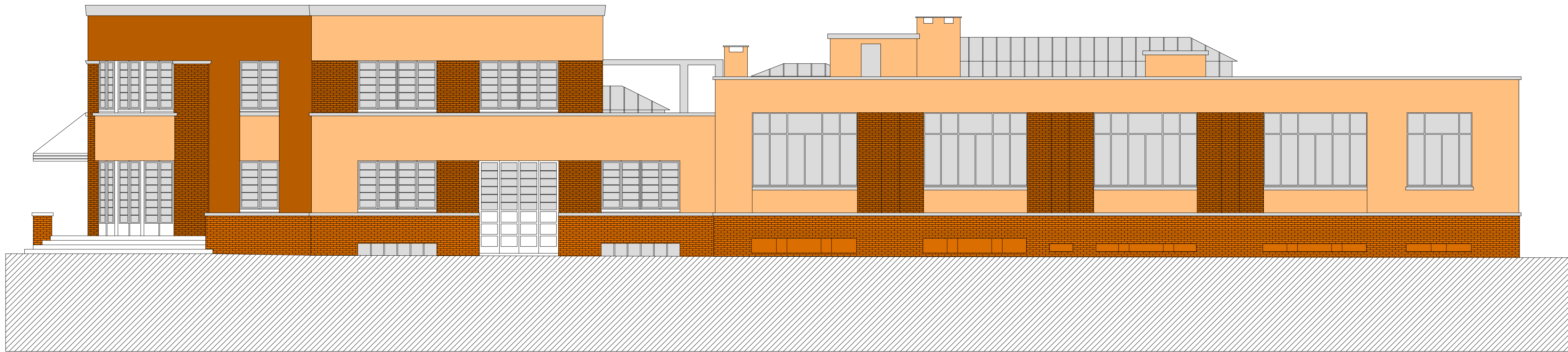

NORDANSICHT PROSPETTO NORD

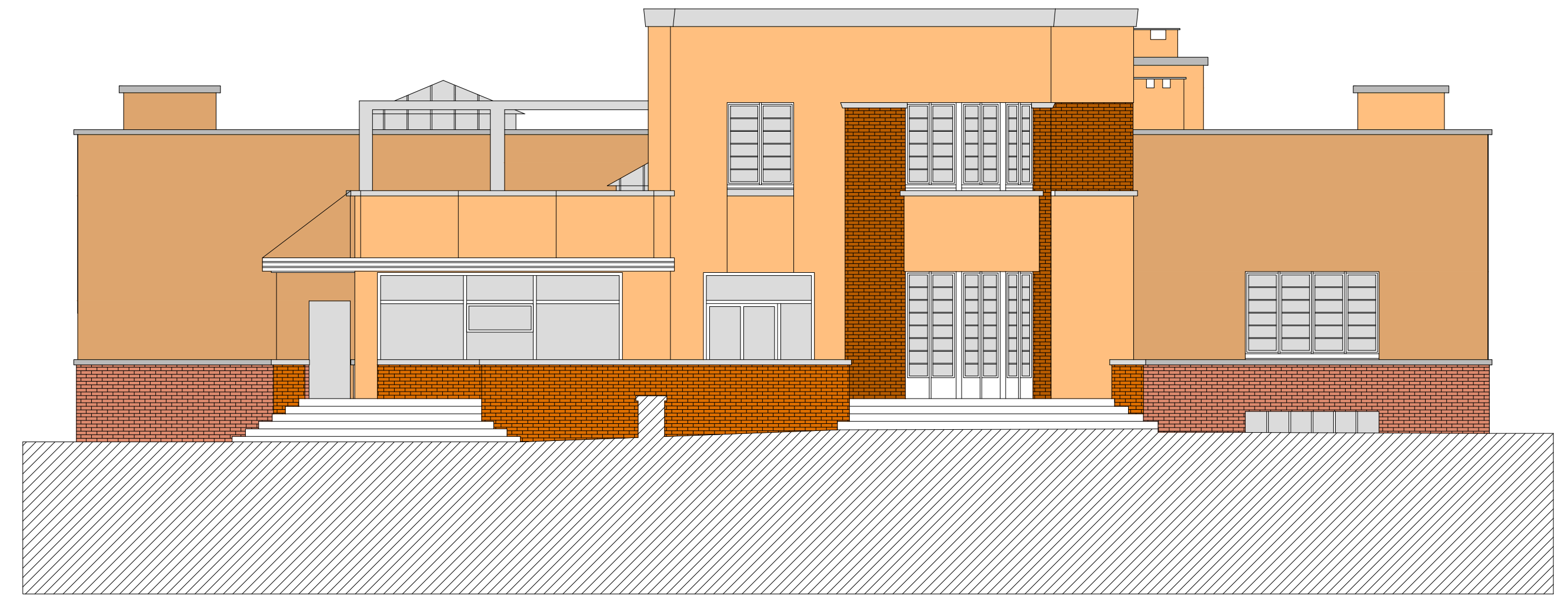

OSTANSICHT PROSPETTO EST

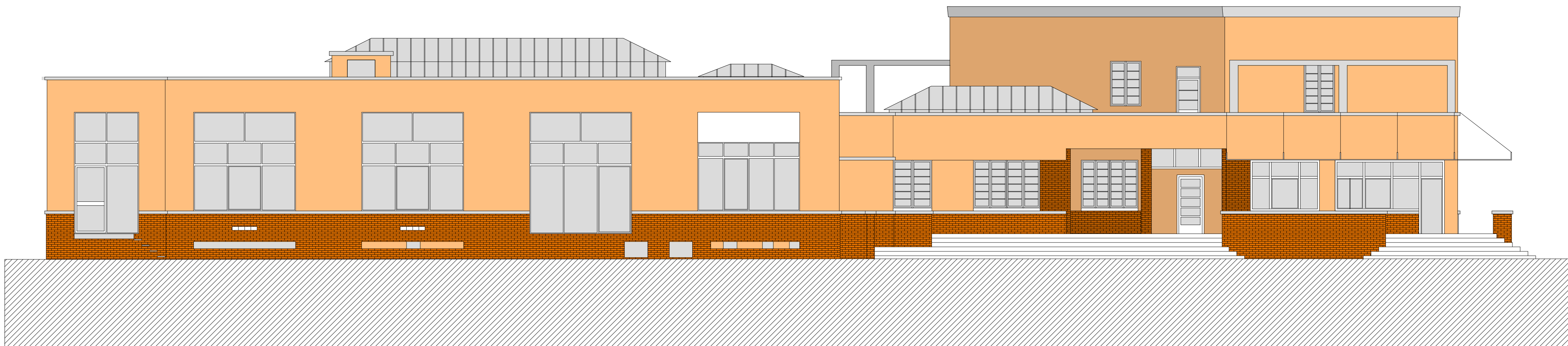

SÜDANSICHT PROSPETTO SUD

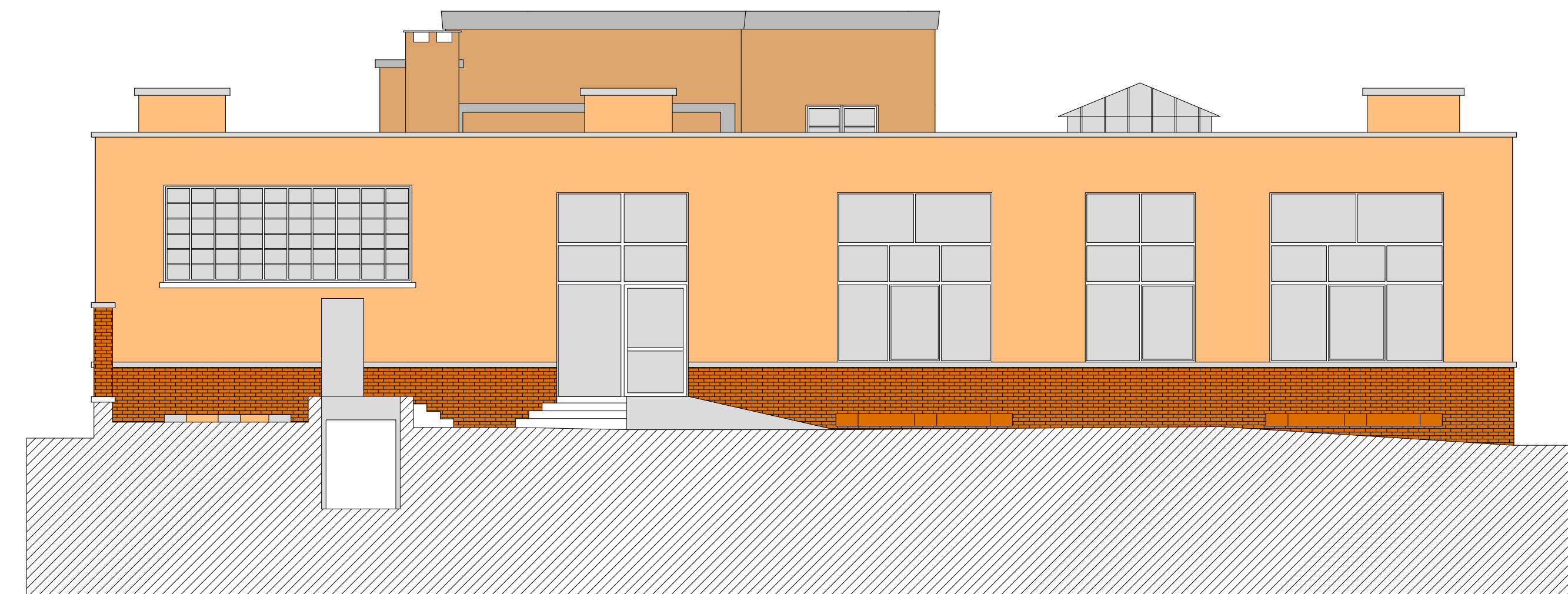

WESTANSICHT PROSPETTO OVEST

Autonome Provinz Bozen-Südtirol



Provincia Autonoma di Bolzano-Alto Adige

Abteilung 10
Tiefbau

Ripartizione 10
Infrastrutture

VERMESSUNG GEBÄUDE "D":
RILIEVO EDIFICIO "D":

EX ALUMIX AREAL B.P. 4108 C.C. ZWÖLFMALGREIEN
AREA EX ALUMIX P.ED. 4108 C.C. DODICIVILLE

2 SCHNITTE — ANSICHTEN
SEZIONI — PROSPETTI

MASSTAB 1:100
SCALA 1:100

STUDIO TECNICO ASSOCIATO GEOM. L. FACCHINI E GEOM. F. TOMMASINI
VIA A. DIAZ nr. 22 — 39100 BOLZANO — TEL. 0471 — 272698